

REMOVABLE MOUNT ROOF RACKS

Product code number: **59806**

Maximum Carrying Capacity: 88 lbs
40 kg

Please read these instructions thoroughly before commencing installation.

ASSEMBLY OF CROSS BARS

- 1 Ensure that the roof is clean; free from dust and grease.
- 2 Pre-assemble End Supports into Cross Bars. They are designed to be a tight fit: use a rubber mallet if necessary (Fig.1).
- 3 Push the rubber Buffer Strip back about 20mm until the screw hole appears (Fig.2). Fit Screw and tighten. Replace Buffer Strip.

NOTE: The Longer Cross Bar assembly is fitted to the Front of the vehicle-check the labelling on the underside of the Cross Bars.

FITTING OF CROSS BARS TO VEHICLE

- 4 Open the vehicle doors. Under the door return you will find Strap locating indents (Flatened section in sheet metal- see Fig 3). Place the rubber pads on the vehicle roof above the location indents (Fig 3). The position of the pads are indicated by the moulding marks on the bottom of the pads (Fig 4) as viewed in the driving position.

FL- Front left side **RL-** Rear left side
FR- Front right side **RR-** Rear right side

- 5 Place the Front and Rear Locking Straps centrally in the location indents (Refer to Fig 3). Push the cage nut on the upper end of the strap into the well of respected pad. Push inboard until the strap is fully engaged around the door return and the Rubber Pad nestles into the longitudinal features of the roof panel. Carefully close the doors to hold the Straps in place until fitment is complete. In the rear position you may need assistance to hold the straps while the rack is applied.

- 6 Sit the Cross Bar assemblies onto the Rubber Pads. Loosely fit the Special Bolt through the end support and into the locking strap. Give two to three turns of the Special Bolt in the Locking Strap with the Security Key provided. Go to the other side of the vehicle and pull on the End support and fit the same. This will allow correct alignment of locking strap and Special bolt thread (Fig 5).

- 7 Gradually tighten bolts alternately ensuring Locking Straps are properly engaged, until even tensioning is achieved.

PLEASE NOTE: When tightening bolts, particular attention should be paid to the gap between the horizontal face of Strap and underside of End Support. A gap of approximately 3mm should be left (Fig.6). Overtightening of the bolts may result in roof damage

FINAL CHECK

Ensure that Cross Bar is parallel and square to the front and rear axis of the vehicle. After loading check bolts tightness and ensure that the Roof Racks are correctly engaged to the vehicle.

USAGE INSTRUCTIONS

Loads should be evenly distributed and secured. A number of accessories for carrying special loads is available, otherwise only use NON-STRETCH tie down straps.

Any weight carried on the vehicle will adversely affect its handling particularly in cornering or in a cross wind and the vehicle should therefore be driven with increased caution.

Fitting Instruction Sheet No.

59806N Issue: A
01/10/08

Toyota
Prius 4d Hatch
11/03 on

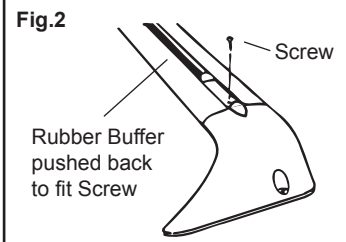
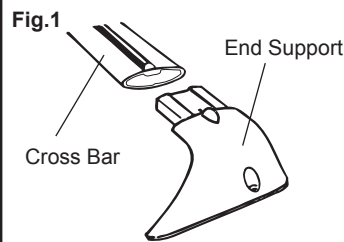

Fig.3 Arrows indicate position of Strap location indents in door return

Place Pad & Locking Strap centrally between location indents in door return.

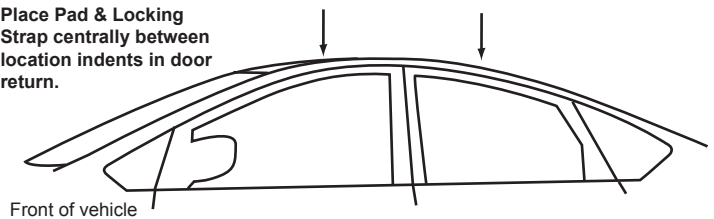

Fig.4

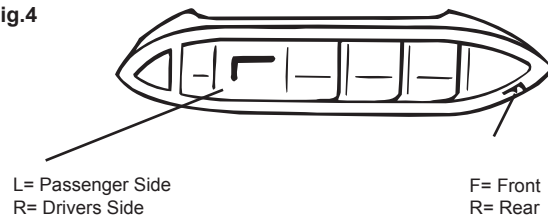

Fig.5

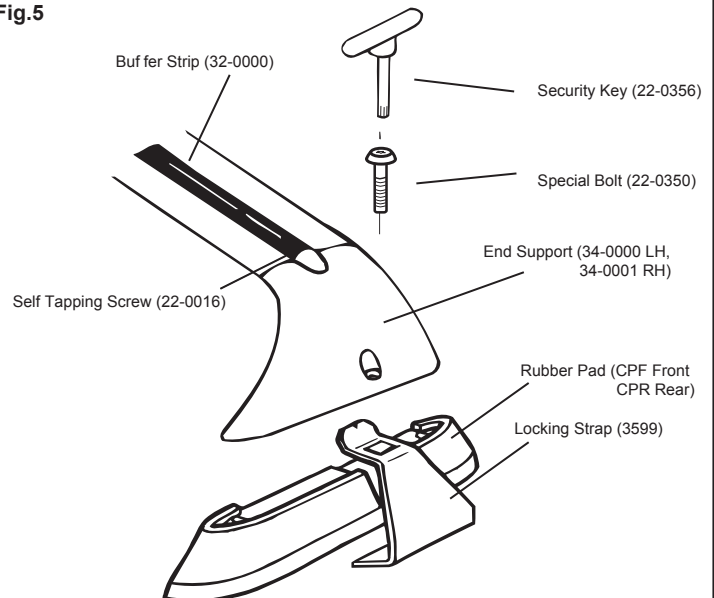
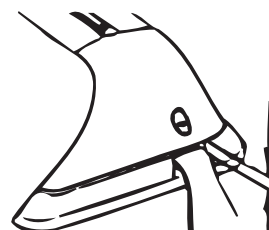

Fig.6



Tension Special Bolt to leave 3-5mm gap between End Support and Top of Locking Strap.
IMPORTANT do not over tension Special Bolt

ROLA
ROOF RACKS

www.rolaproducts.com

Cequent Towing Products - Plymouth, MI
Technical Service: (888)521-0510